

Application for Hire Form - Jack McLean Community Recreation Centre



APPLICATION FOR HIRE FORM FOR JACK MCLEAN COMMUNITY RECREATION CENTRE

Hire Application details

Must be completed by the client who is paying the account

I am 18 or over (please provide proof, eg driver licence, passport)

| | |
|--------------------|----------------|
| Full name of Hirer | |
| Company name | |
| Phone number | Postal address |
| Email address | |

Details of person responsible for care of the Centre during your occupation

| | |
|---|------------|
| Contact name | |
| Phone number | Cell phone |
| Nominated Fire Warden (if different from above person) | Cell phone |

I understand that I am liable for any damage caused during my use of the facility above normal wear and tear.

What is the purpose for the hire of Jack McLean Community Recreation Centre?

| |
|-----------------------|
| Activity full details |
| |
| |
| |

Dates required?

| | |
|---|----------------|
| Specify times e.g. Saturday 18th May, 8.00am - 4.00pm to Sunday 19th May, 9.00am - 4.00pm | _____ to _____ |
|---|----------------|

Note: The Recreation Centre is available for use from 5:30am to 10:30pm daily.

Numbers attending?

| |
|----------------------------|
| _____ (max occupancy: 612) |
|----------------------------|

Access card

I agree to pay \$150 for each lost access card

Proof of address provided (eg utility bill with name and address) 

I understand that hire fees for the facility must be paid before an access card will be provided

I understand that the access card will only be provided to the person named in the Hire Application details section

*Office
use only*

Proof of address received?

YES

NO

Proof of ID received?

YES

NO

Signature

Date (DD/MM/YYYY)

I would like to book:

Court 1

Court 2

Multi-purpose Room

Whole facility

Information

For more information, please contact our:

Customer Services Team

Phone: 07 868 0200

Fax: 07 868 0234

Email: customer.services@tcdc.govt.nz

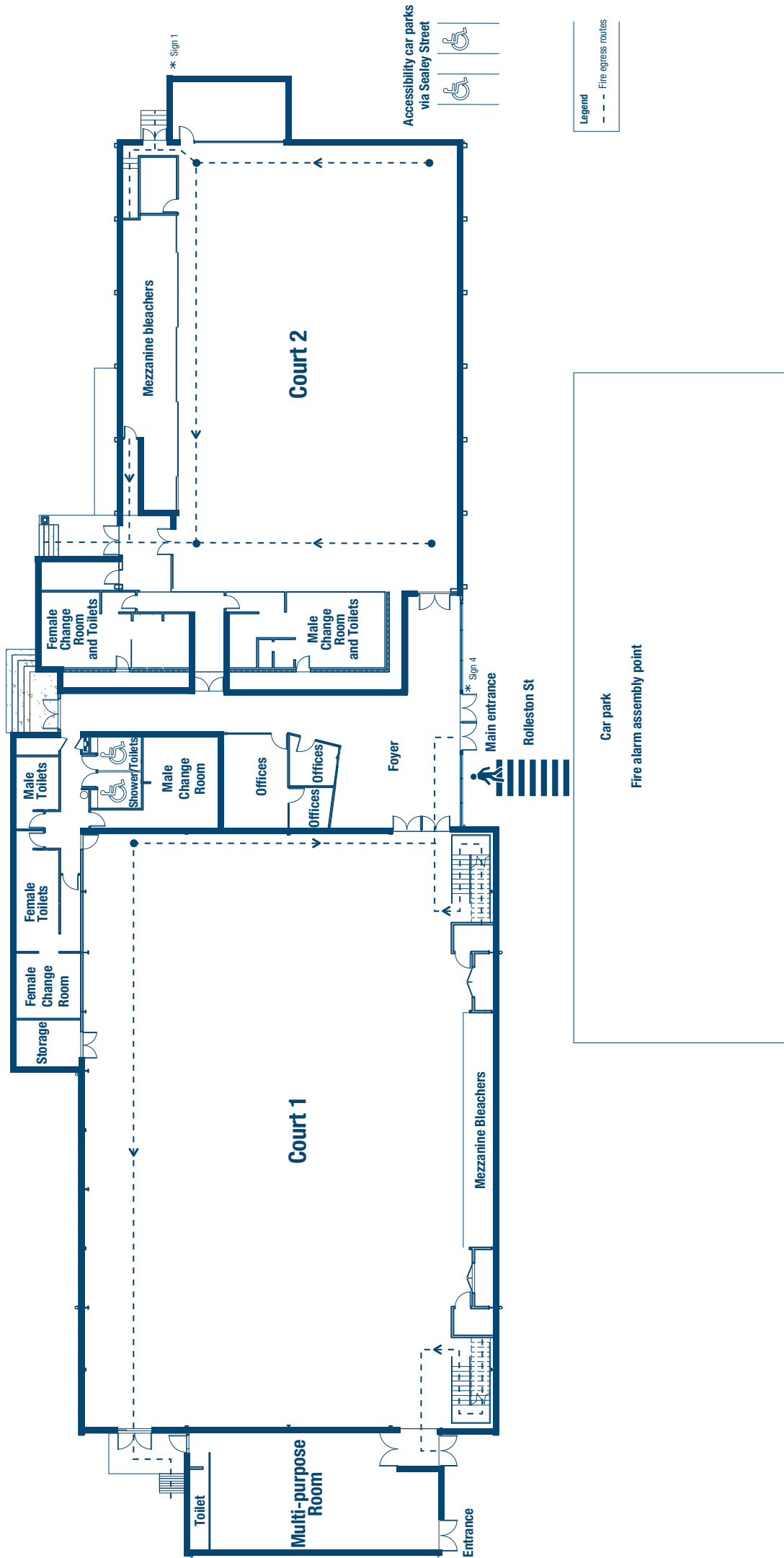

Customer Services Team
 Phone: 07 868 0200
 Fax: 07 868 0234
 Email: customer.services@tcdc.govt.nz