



# THAMES AQUATIC PROVISION

## SUMMARY OF OPTIONS April 2024



# SEEKING FEEDBACK ON AQUATIC OPTIONS

Thames-Coromandel District Council is considering the development of a new aquatic facility to replace Thames Centennial Pool. This document outlines four options we are seeking community feedback on.

Find out more about these options in this document and provide your feedback through the survey available at [tcdc.govt.nz/poolsurvey](https://tcdc.govt.nz/poolsurvey)

## WHY ARE WE CONSIDERING A NEW POOL?

### Agreement to remove pool

Thames-Coromandel District Council and Ngāti Maru have agreed to remove Thames Centennial Pool due to its location on a sacred urupā (burial ground).

### Thames Pool at end of life and not fit-for-purpose

At 50 years old, Thames Centennial Pool is reaching the end of its useful life. The design of the pool is not fit-for-purpose to meet current and future community needs.

### Under-supply of all-year water

Waikato Regional Aquatic Plan 2017 identifies an under-supply of all-year aquatic provision and lack of warm water in Thames-Coromandel.

## WHAT OPTIONS ARE BEING CONSIDERED?

### Option A

Local Indoor Pool –  
small facility – at Thames  
High School

### Option B

Local Indoor/Outdoor Pool  
– small facility – at Thames  
High School

### Option C

Sub-regional Indoor Pool –  
larger facility – at  
Kōpū South

### Option D

No investment, Thames  
Centennial Pool removed  
in 2027

# HOW HAVE WE GOT TO THIS POINT?

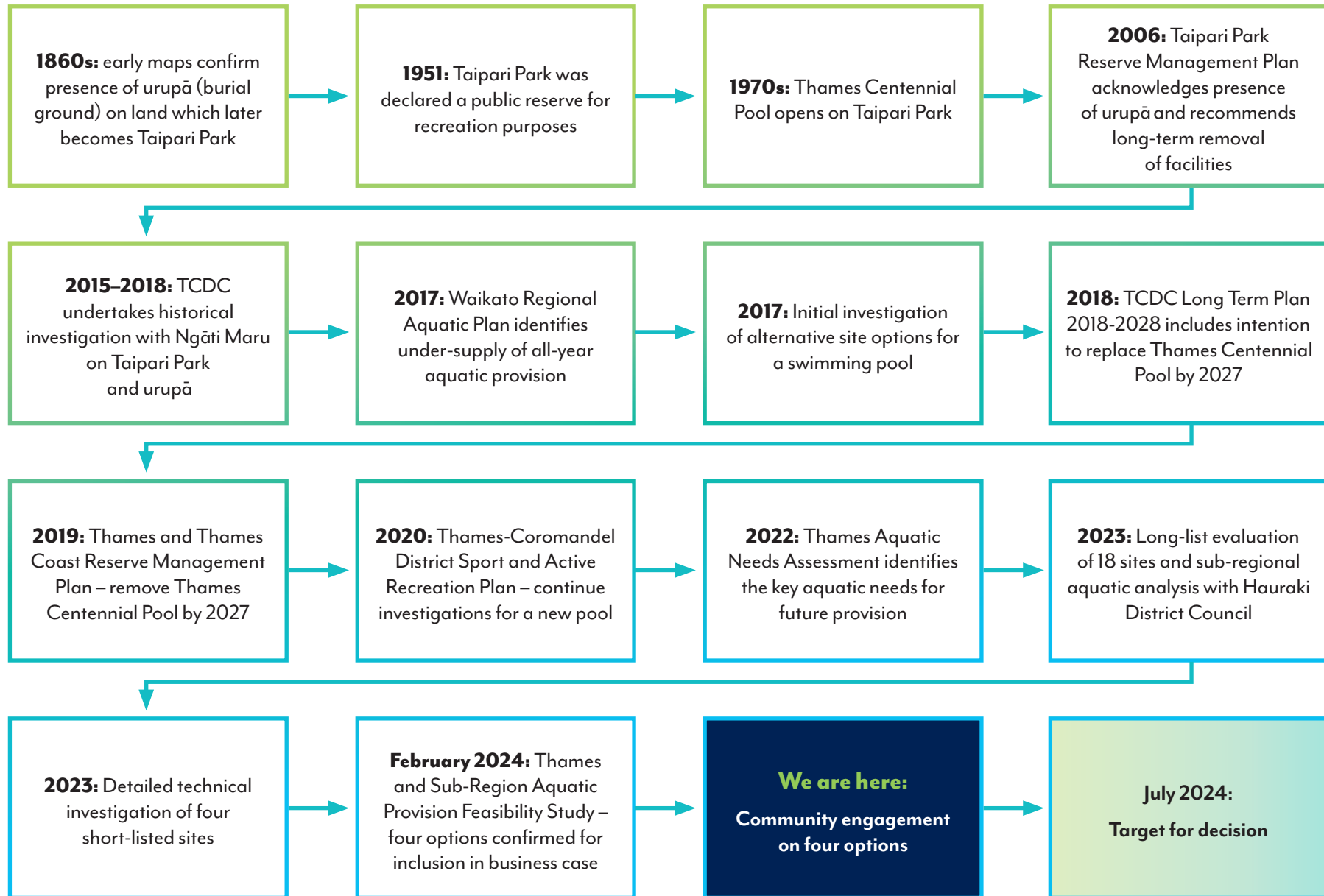

# WHAT ARE THE IMPORTANT AQUATIC NEEDS?

Current aquatic provision is structured, inflexible, cold and ageing.  
Clear community desire for indoor and warm water.



Thames has an ageing population with an increasing number of people over 65 years and fewer children and young adults



Thames' population has below-average income, meaning affordability is very important

## PRIORITIES FOR FUTURE AQUATIC PROVISION



Learn to swim



Lap pool



Fun water



Warm water for relaxing



Good location



Less priority for deep water for sport

## OPTION A:

# LOCAL INDOOR POOL, THAMES HIGH SCHOOL



### What is included?

1. 25m, 7-lane lap pool 1.4m to 2m deep, 25–27°C
  2. Small 25m spa pool
  3. Programme pool, 1.3m deep, 30–32°C
  4. Learn-to-swim pool, 0.9m deep, 30–32°C
  5. Toddlers pool and splash-pad, 30–32°C
  6. Small outdoor area
- Changing rooms and small amount of carparking
- 800m<sup>2</sup> of water (430m<sup>2</sup> in current Centennial Pool)

### What are the estimated costs?

- **To build: up to \$42.5 million** – Council has already allocated \$40 million in the 2024-2034 Long Term Plan
- **To operate: up to \$300,000** more per year compared to the existing pool

## OPTION B:

# LOCAL INDOOR/OUTDOOR POOL, THAMES HIGH SCHOOL

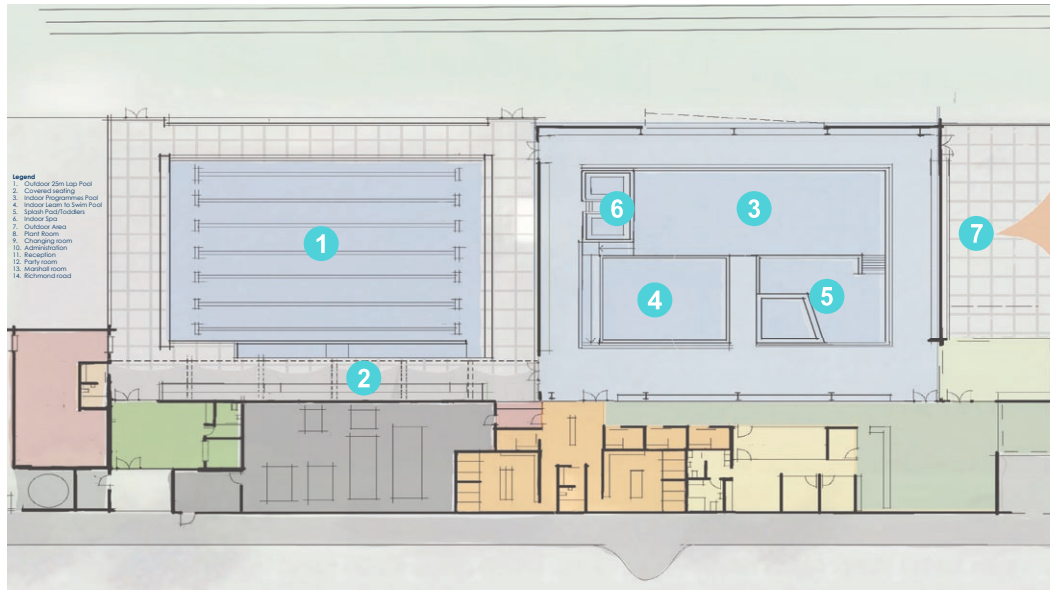

### What is included?

- |   |  |
|---|--|
| 1. OUTDOOR 25m, 7-lane lap pool<br>1.4m to 2m deep, 25–27°C | 5. INDOOR toddlers pool and splash-<br>pad, 30–32°C                                |
| 2. Covered seating  | 6. INDOOR small spa pool   |
| 3. INDOOR programme pool, 1.3m<br>deep, 30–32°C             | 7. Small outdoor area  |
| 4. INDOOR learn-to-swim pool, 0.9m<br>deep, 30–32°C         | Changing rooms and small amount<br>of carparking                                   |
|   | <i>800m<sup>2</sup> of water (430m<sup>2</sup> in current<br/>Centennial Pool)</i> |

### What are the estimated costs?

- **To build: up to \$36.5 million** – up to \$7.5 million less than the \$40 million in the 2024-2034 Long Term Plan
- **To operate: up to \$500,000** more per year compared to the existing pool

# OPTION C:

# SUB-REGIONAL INDOOR POOL, KŌPŪ SOUTH

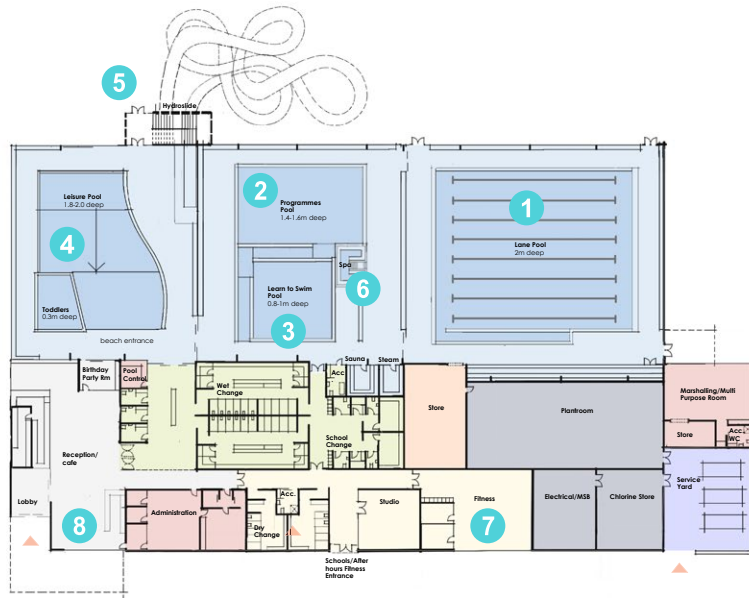

## What is included?

- |  |                         |
|--|-------------------------|
| 1. 25m, 8-lane lap pool, 2m deep, 25–27°C                          | 5. Potential hydroslide |
| 2. Hydrotherapy programme pool, 1.4–1.6m deep, 30–32°C             | 6. Spa pool             |
| 3. Learn-to-swim pool, 0.8–1m deep, 30–32°C                        | 7. Fitness centre       |
| 4. Large leisure/toddler pool, beach style to 1.8–2m deep, 30–32°C | 8. Cafe                 |
- Changing rooms and carparking  
1,100m<sup>2</sup> of water (430m<sup>2</sup> in Centennial Pool)

## What are the estimated costs?

- **To build: up to \$77 million** – this will require up to \$37 million more than current funding in the Long Term Plan
- **Potential funding sources** are being explored, with potential for \$2–5 million of external funding.
- **To operate: up to \$830,000** more per year compared to the existing pool

## OPTION D:

# NO INVESTMENT IN AQUATIC PROVISION

This option means Thames-Coromandel District Council will not invest in a new swimming pool and Thames Centennial Pool will be removed in 2027. As a result, the Council will not own an aquatic facility in Thames as it currently does.

### What is included?

- No new swimming pool
- Close and demolish Thames Centennial Pool in 2027

### What are the estimated costs?

- **To demolish** Thames Centennial Pool and restore Taipari Park: up to \$550,000
- **To operate:** reduction of \$700,000 per annum

## HOW TO PROVIDE FEEDBACK & GET FURTHER INFORMATION

### DO IT ONLINE

[tcdc.govt.nz/poolsurvey](https://tcdc.govt.nz/poolsurvey)

To:

- Read more, find information
- Complete the digital survey

### FACE TO FACE

**Tuesday 23 April 2024**

**11am–1pm or 4–6pm**

**Thames Bowling Club, 512 Mackay St**

To:

- Hear more, ask questions
- Get help completing survey

### OLD SCHOOL

**Council offices** – 515 Mackay St

**Thames Library** – 503 Mackay St

**Thames Centennial Pool** – 105 Mackay St

To:

- Pick-up and drop-off a paper survey

**Please provide your feedback online before midnight or hand in your completed paper survey by 4.30pm on Monday 6 May 2024.**