

MANHOLE COVER PLAN

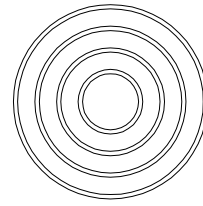

MANHOLE COVER SECTION

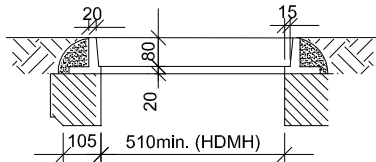
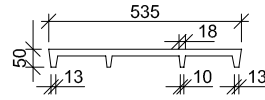
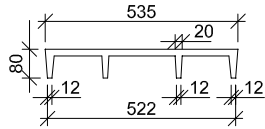

MANHOLE FRAME SECTION

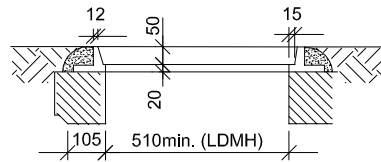

HEAVY DUTY

LIGHT DUTY

CAST IRON FRAME & COVER

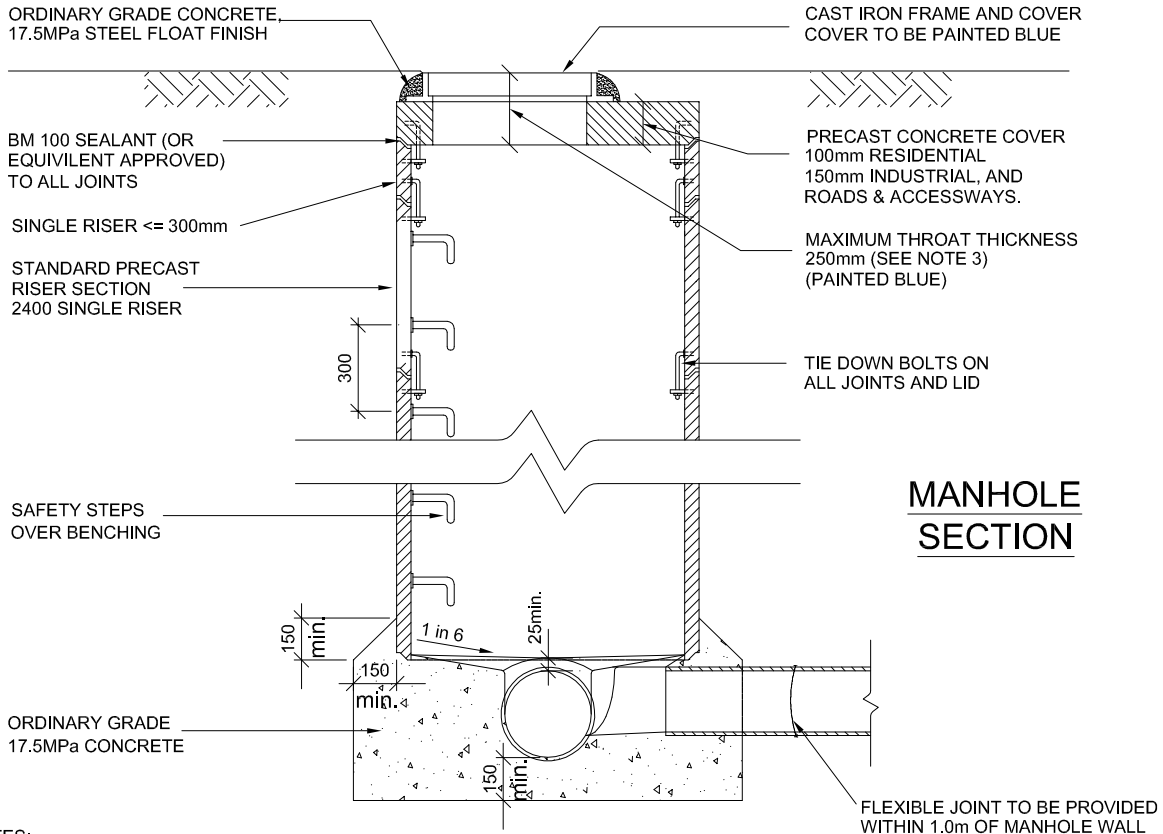

MANHOLE SECTION

NOTES:

1. For pipes greater than 600mm dia, manholes are to be specifically designed.
2. For pipes 1200 dia & greater, manholes to be factory fabricated bends with riser off-taker.
3. May increase to 350mm with heavy duty lids where fixed surface levels are to be matched.



STANDARD DETAIL:

STORMWATER MANHOLE

DATE: June 2010
NOT TO SCALE

TCDC NO: SHEET NO: REV:

6000 1